

INSTRUCTIONS AND OPTIONS

MODEL NO.: 001
DESCRIPTION: 25 LNCH

CP-ASSM01
INSTRUCTIONS & OPTIONS

MADE IN THE USA

PATENT PENDING



visit: holdmycargo.com

FOR MORE INFORMATION PLEASE VISIT HOLDMYCARGO.COM

INSTALLATION INFORMATION

½ Ton GMC, Chevrolet owners refer to sheets 3 & 4 of instructions for HORIZONTAL mounting CargoPost at the extreme front of the pickup truck bed behind truck cab using U-Bolt provided by the manufacturer.

½ Ton Dodge, CargoPost can be mounted Horizontal or Vertical in the extreme front of pickup bed (refer to sheets 3 & 4).

½ Ton GMC, Chevrolet and Dodge owners refer to sheet 3 of instructions for VERTICAL mounting CargoPost at the REAR of the pickup truck bed using U-Bolt provided by the manufacturer.

¾ Ton GMC, Chevrolet and Dodge owners refer to sheet 3 of instructions for mounting at the front and rear of the pickup truck bed using the U-Bolt supplied by vehicle manufacturer.

ATTENTION – Refer to vehicles owner's manual for proper installation locations for cargo accessories.

When a U-Bolt is NOT PROVIDED by the manufacturer to install CargoPost in pickup truck bed please refer to sheets 5 thru 8 of the instructions for Drill and Riv-Nut installation options.

Please visit holdmycargo.com for more information and pictures of CargoPost

INSTRUCTIONS AND OPTIONS

MODEL NO.: 001
DESCRIPTION: 25 LNCH

CP-ASSM01
INSTRUCTIONS & OPTIONS

COMPLETE KIT

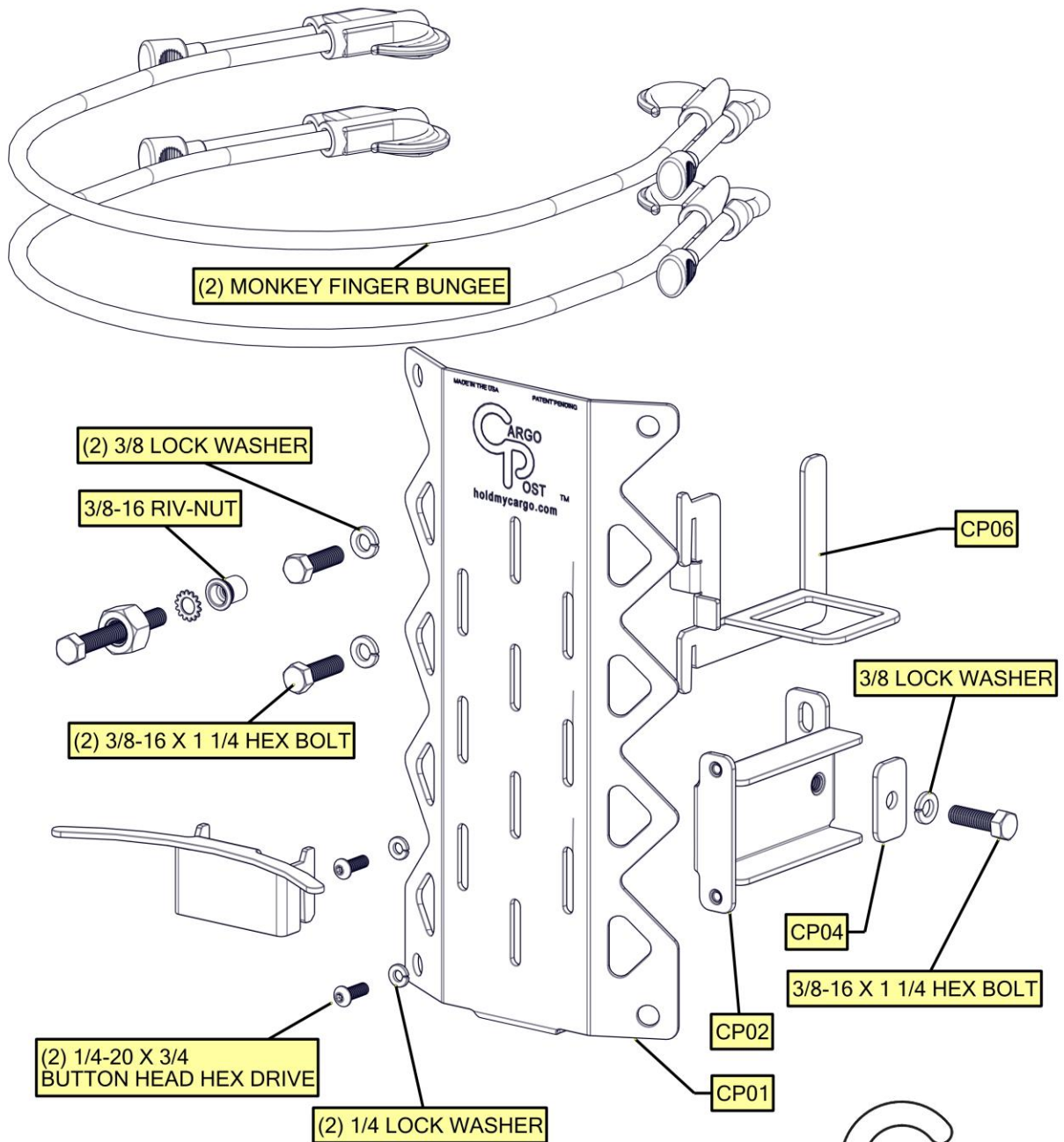

CARGO
OST
holdmycargo.com

INSTRUCTIONS AND OPTIONS

MODEL NO.: 001
DESCRIPTION: 25 LNCH

CP-ASSM01
INSTRUCTIONS & OPTIONS

TYPICAL INSTALLATION USING EXISTING TRUCK U-BOLT

(NO DRILLING REQUIRED)

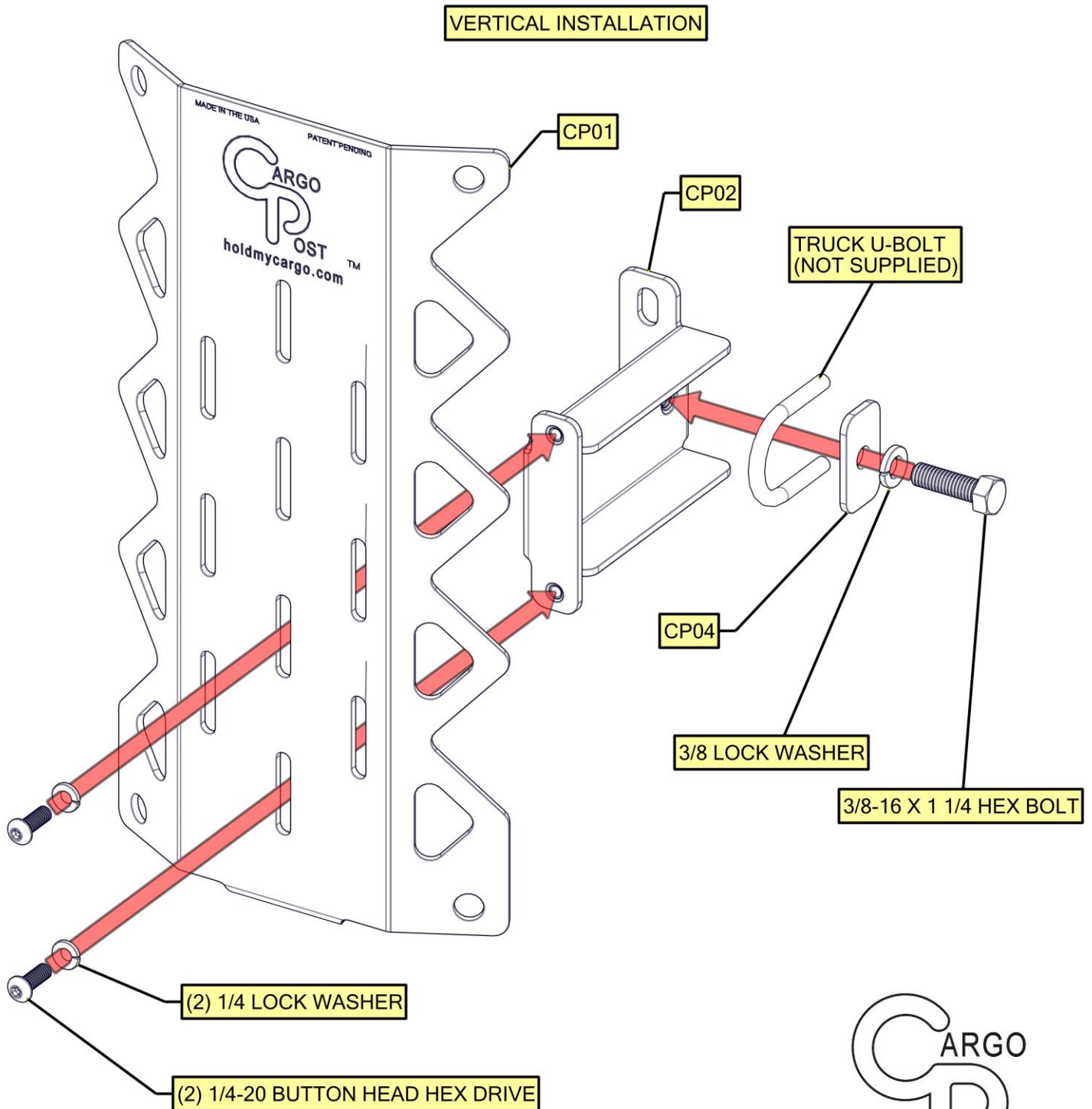

CARGO
OST
holdmycargo.com

INSTRUCTIONS AND OPTIONS

MODEL NO.: 001
DESCRIPTION: 25 LNCH

CP-ASSM01
INSTRUCTIONS & OPTIONS

TYPICAL INSTALLATION USING EXISTING TRUCK U-BOLT

(NO DRILLING REQUIRED)

HORIZONTAL INSTALLATION

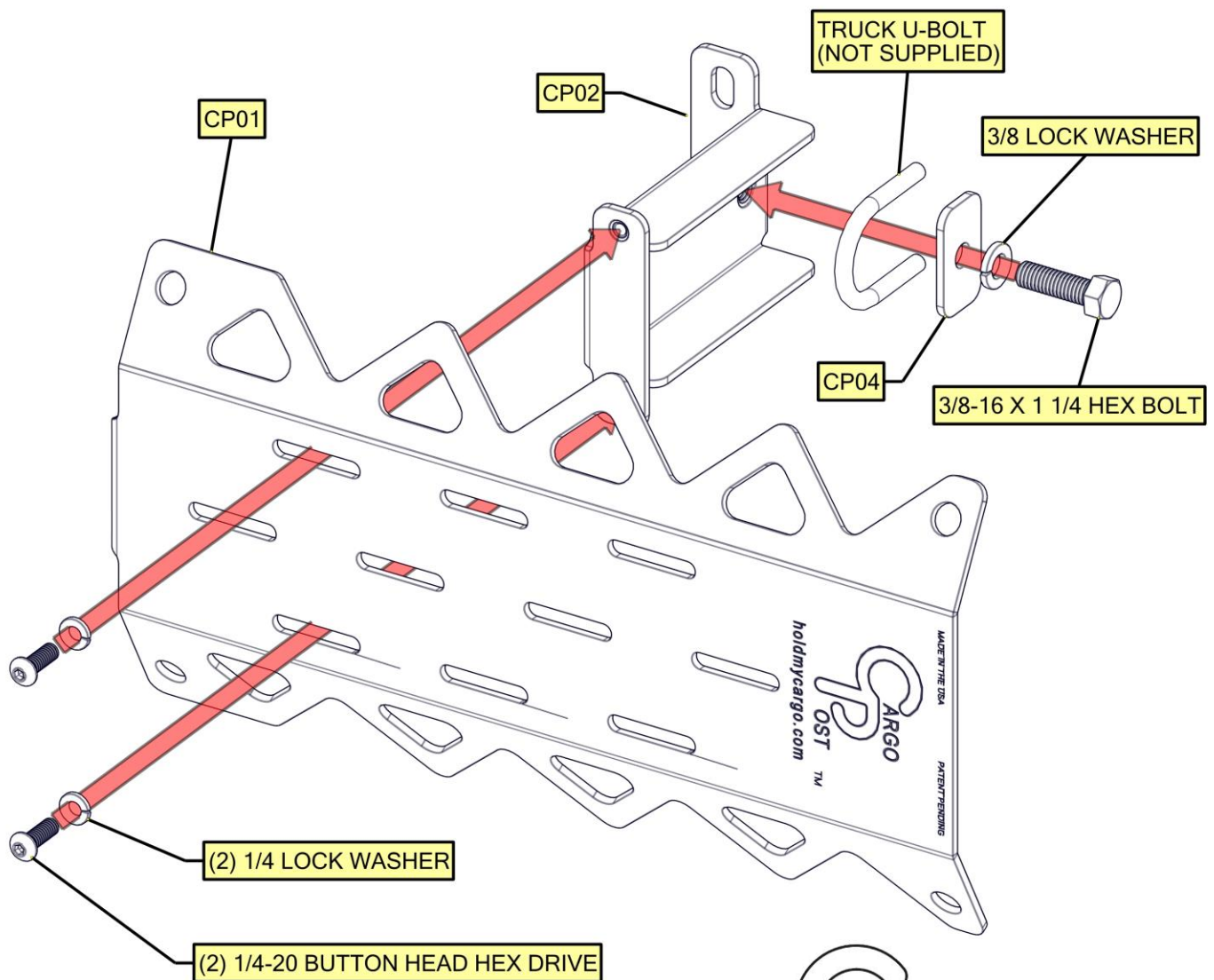

ARGO
OST™
holdmycargoo.com

MODEL NO.: 001
DESCRIPTION: 25 LNCH

CP-ASSM01
INSTRUCTIONS & OPTIONS

- 1) DETERMINE WHETHER VERTICAL OR HORIZONTAL INSTALLATION IS NEEDED
- 2) PRE-ASSEMBLE CARGO POST TO LOCATE DRILL LOCATIONS NEEDED
- 3) MARK DRILL LOCATIONS AND REMOVE CARGO POST
- 4) PROCEED TO “RIV-NUT COMPONENTS INSTALLATION ASSEMBLY” STEP



INSTRUCTIONS AND OPTIONS

MODEL NO.: 001
DESCRIPTION: 25 LNCH

CP-ASSM01
INSTRUCTIONS & OPTIONS

RIV-NUT COMPONENTS INSTALLATION ASSEMBLY

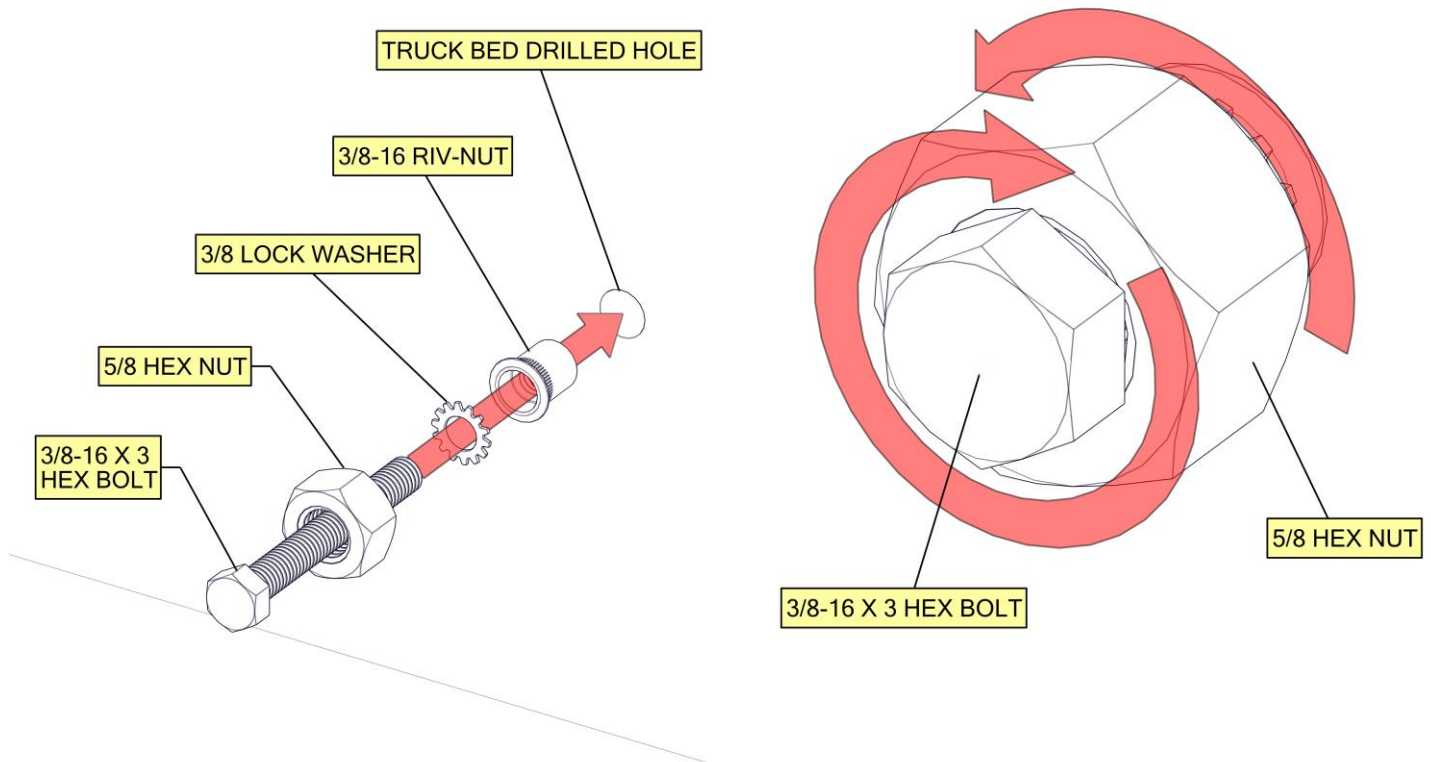

OPERATION TO DRILL & TIGHTEN RIV-NUT

- 1) DRILL BOTH MARKED HOLE LOCATIONS TO 17/32" (.531") DIAMETER THRU INNER BOX WALL ONLY
- 2) INSTALL ASSEMBLY INTO DRILLED HOLE AS SHOWN ABOVE
- 3) HOLD LARGE 5/8 NUT FROM SPINNING WITH 15/16" WRENCH
- 4) TIGHTEN 3/8 HEX HEAD BOLT TO PULL & COMPRESS RIVET INSIDE TRUCK WALL USING 9/16" WRENCH
- 5) REMOVE HEX BOLT BY TURNING IN OPPOSITE DIRECTION
- 6) USE BOLT, JAM NUT & WASHER TO REPEAT ON 2ND DRILLED HOLE
- 7) MULTIPLE INSTALLATION VIDEOS ARE AVAILABLE ONLINE FOR MANUALLY INSTALLING RIV-NUTS

INSTRUCTIONS AND OPTIONS

MODEL NO.: 001
DESCRIPTION: 25 LNCH

CP-ASSM01
INSTRUCTIONS & OPTIONS

FASTENING CARGO POST VERTICALLY TO INSTALLED RIV-NUTS

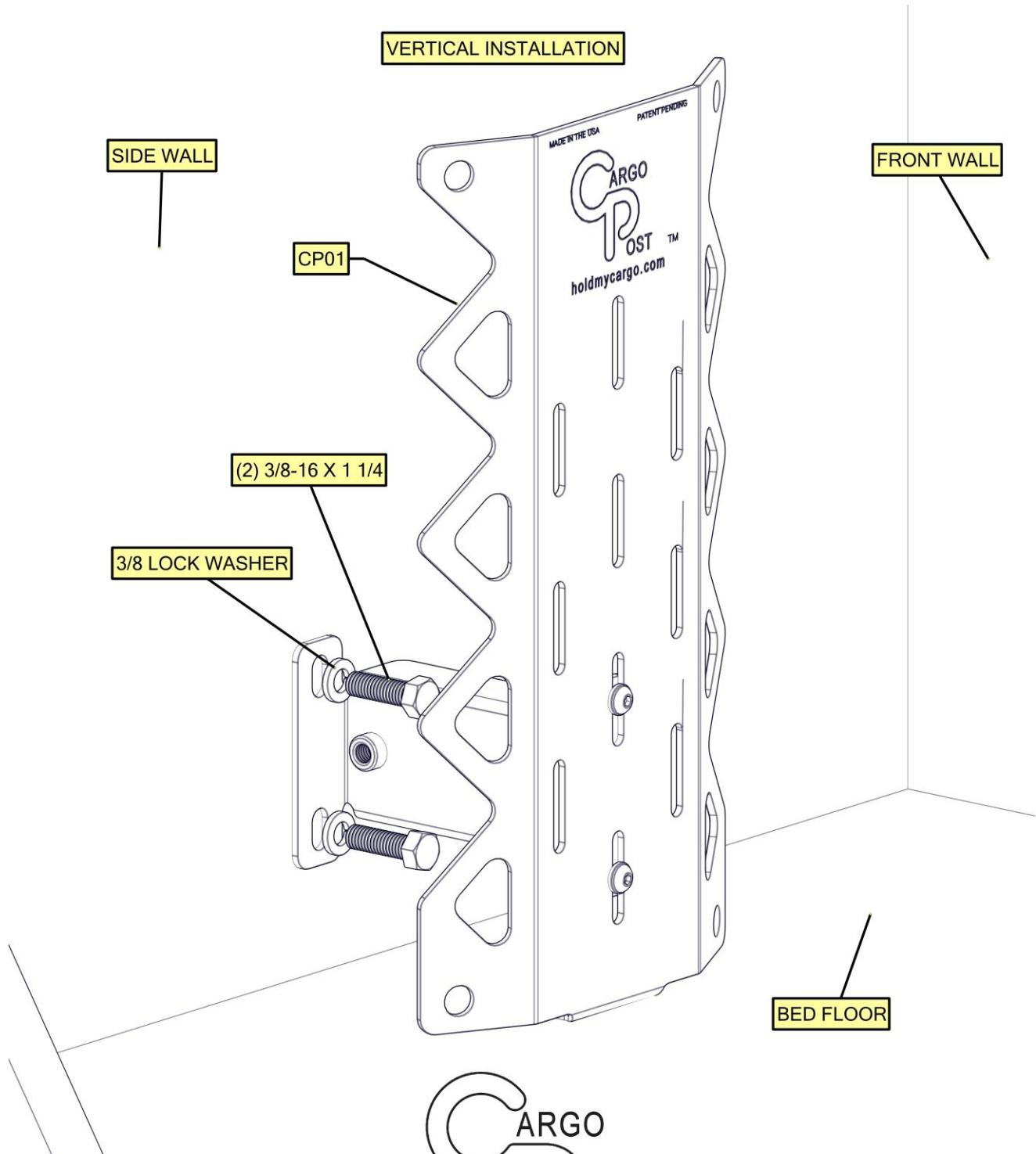

CARGO
POSTTM
holdmycargo.com

INSTRUCTIONS AND OPTIONS

MODEL NO.: 001
DESCRIPTION: 25 LNCH

CP-ASSM01
INSTRUCTIONS & OPTIONS

FASTENING CARGO POST HORIZONTALLY TO INSTALLED RIV-NUTS

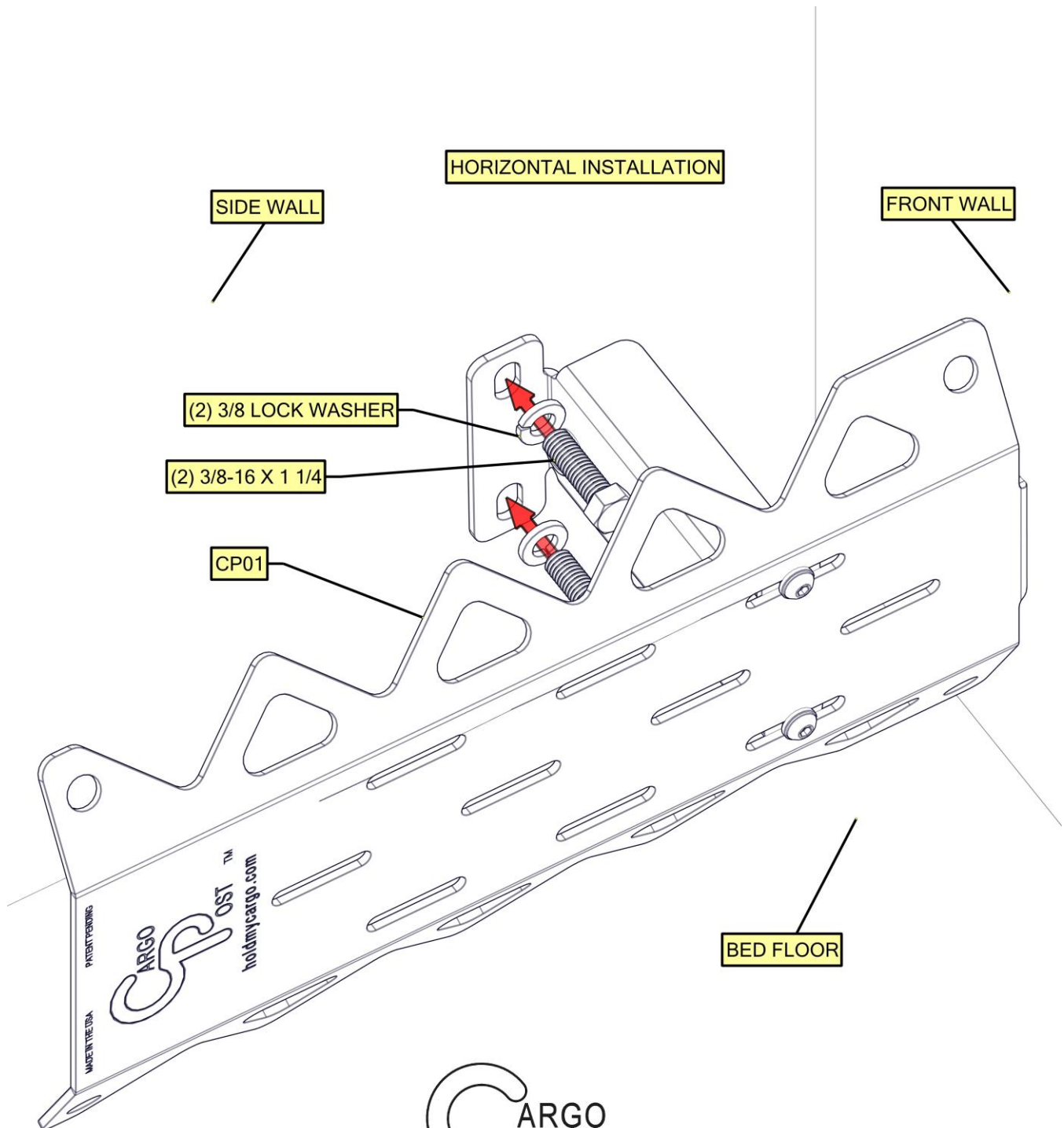

INSTRUCTIONS AND OPTIONS

MODEL NO.: 001
DESCRIPTION: 25 LNCH

CP-ASSM01
INSTRUCTIONS & OPTIONS

CARGO POST SHOWING SOME TYPICAL FUNCTIONS

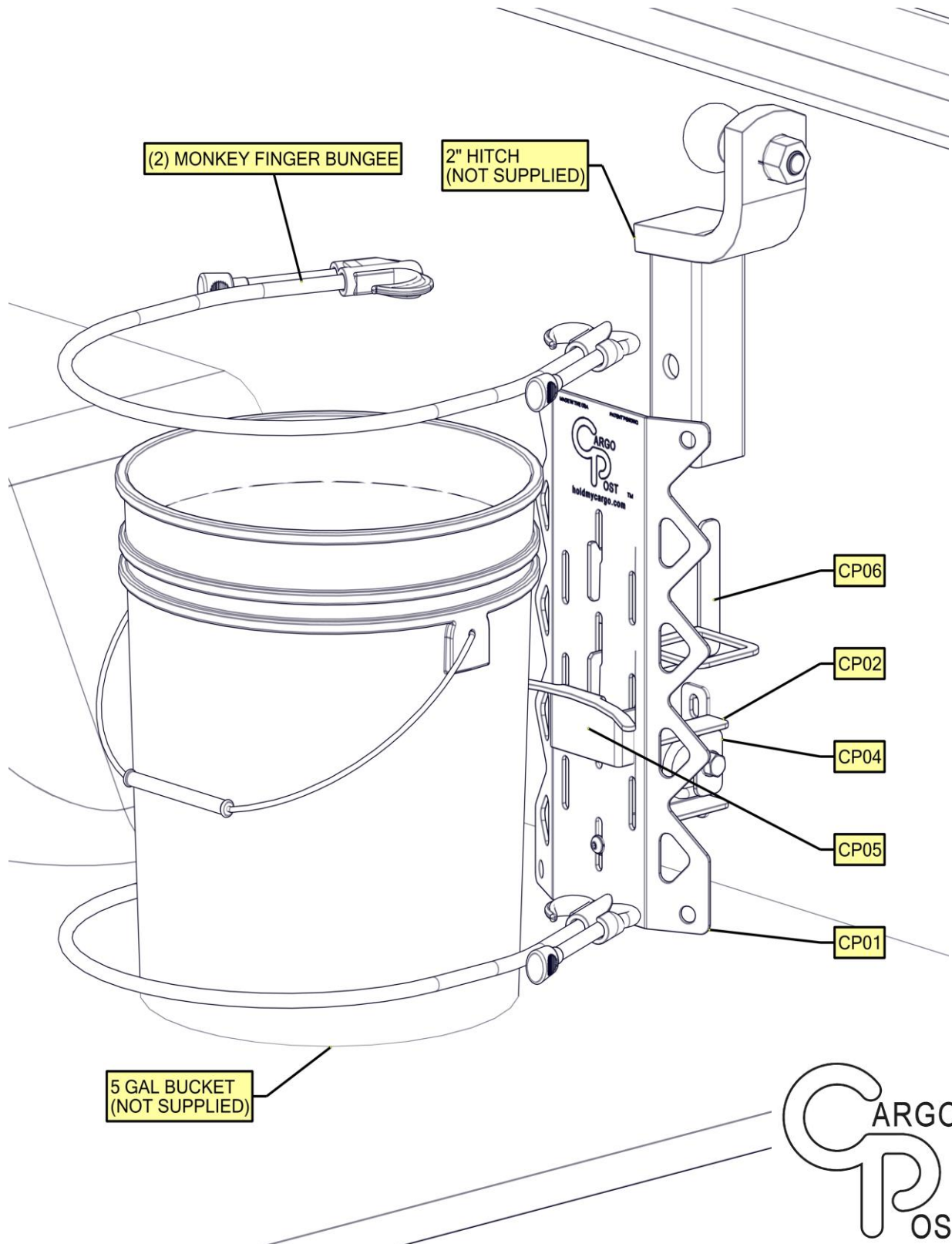

CARGO
POST™
holdmycargo.com

INSTRUCTIONS AND OPTIONS

MODEL NO.: 001
DESCRIPTION: 25 LNCH

CP-ASSM01
INSTRUCTIONS & OPTIONS

***ATTENTION: DO NOT USE SHEET 6 FOR RIV-NUT INSTALLATION!**

FOLLOW THIS PAGE INSTEAD FOR:

FASTENING CARGO POST VERTICALLY USING 3/8 HARDWARE PROVIDED

VERTICAL INSTALLATION

